

CESB 07
Final Invitation
Konečná pozvánka



Host: **CSBS iiSBE Czech**
Czech Sustainable Building Society
Česká společnost pro udržitelnou
výstavbu budov
www.substance.cz/csbs

CESB 07 PRAGUE

International Conference
Central Europe towards Sustainable Building

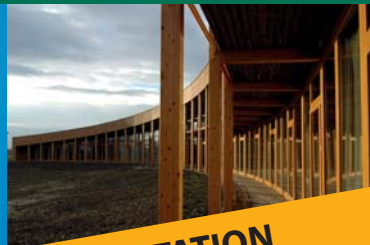

FINAL INVITATION

KONEČNÁ POZVÁNKA

Central Europe towards Sustainable Building Udržitelná výstavba budov ve střední Evropě

Final Invitation
Konečná pozvánka

PRA HA
PRA GUE
PRA GA
PRA G

CESB 07 PRAGUE Secretariat
cesb@cbsservis.eu
www.cbsservis.eu/cesb07

CESB 07 PRAGUE
International Conference
24-26 September 2007
Faculty of Civil Engineering
CTU in Prague
Thakurova 7, Prague 6
Czech Republic

General partner | Generální partner

SKANSKA

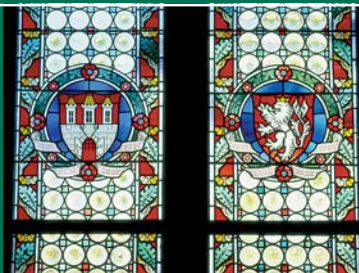

CESB 07 PRAGUE conference will be held on the occasion of celebration of the 300th anniversary of the establishment of the Czech Technical University in Prague



CONFERENCE PROGRAMME AT A GLANCE

SUNDAY, 23 SEPTEMBER 2007

19:00-21:00

WELCOME RECEPTION: Faculty of Civil Engineering, CTU in Prague, Atrium

MONDAY, 24 SEPTEMBER 2007

TIME	HALL A	HALL B	HALL C	FOYERS	
08:30-09:00				POSTER SESSION	EXHIBITION
09:00-10:30	SESSION M1A: Conference opening Welcome addresses Keynote lectures 1				
10:30-11:00					
11:00-12:30	SESSION M2A: Keynote lectures 2				
12:30-14:00					
14:00-15:30	SESSION M3A: Economy, policy and legislation 1	SESSION M3B: Building design 1	SESSION M3C: Energy 1		
15:30-16:00					
16:00-17:30	SESSION M4A: Economy, policy and legislation 2	SESSION M4B: Building design 2	SESSION M4C: Energy 2		
17:30-18:00					

TUESDAY, 25 SEPTEMBER 2007

TIME	HALL A	HALL B	HALL C	FOYERS	
08:30-09:00				POSTER SESSION	EXHIBITION
09:00-10:30	SESSION T1A: Keynote lectures 3				
10:30-11:00					
11:00-12:30	SESSION T2A: Assessment methods 1	SESSION T2B: Building design 3	SESSION T2C: Energy 3		
12:30-14:00					
14:00-15:30	SESSION T3A: Assessment methods 2	SESSION T3B: Building design 4	SESSION T3C: Materials 1		
15:30-16:00					
16:00-17:30	SESSION T4A: Assessment methods 3	SESSION T4B: Internal environment	SESSION T4C: Materials 2		
17:30-18:00					
18:00-20:00					
20:00-24:00	SOCIAL EVENING: Bethlehem Chapel				

WEDNESDAY, 26 SEPTEMBER 2007

TIME	HALL A	HALL B	HALL C	FOYERS	
08:30-09:00				POSTER SESSION	EXHIBITION
09:00-10:30	SESSION W1A: Education and information 1	SESSION W1B: External environment 1	SESSION W1C: Materials 3		
10:30-11:00					
11:00-12:30	SESSION W2A: Education and information 2	SESSION W2B: External environment 2	SESSION W2C: Materials 4		
12:30-12:40					
12:40-13:30	SESSION W3A: Panel discussion Conference closing				
13:30-14:30					



INVITATION BY THE CHAIRMAN OF CSBS iSBCE CZECH



On behalf of the CSBS iSBCE Czech, it is a great honour for me to invite you to the CESB 07 PRAGUE International Conference on sustainable building. Buildings represent an essential element of the built environment created for preserving the quality of human life. Buildings, in their construction and operations, are major consumers of primary materials and energy resources, and generate large amounts of environmental pollutants as well. It is well known that buildings in developed countries are responsible for about 30 or 40% of the total energy consumption and are responsible for a similar share of production of carbon dioxide, waste and other pollutants. The development of new technologies, the utilization of new progressive materials and advanced construction solutions leading to quantitative improvements of buildings, not only in the economic sense, but also in an environmental and socio-cultural perspective, represents a huge potential for sustainable society development. The population growth, depletion of primary materials, energy and drinking water resources, deterioration of the environment (including the consequences of global warming in the form of higher frequencies of natural disasters) necessarily lead to more intensive searches for new environmentally suitable approaches and solutions. The sustainable building offers many opportunities for significant advancement in our Central European region. We are looking forward seeing you at CESB 07 in Prague!

Prof. Petr Hajek, Chairman

OBJECTIVE OF CESB 07 CONFERENCE

The CESB 07 PRAGUE Conference is a part of a 2007 international conference series organized by iSBCE in different regions of the world. The main focus of these conferences is design and construction of sustainable buildings. The Prague CESB 07 – Central Europe towards Sustainable Building conference intends to cover primarily the regions of Austria, Czech Republic, Germany, Hungary, Poland, Slovakia, Slovenia and Switzerland. The main goal of the conference is to provide an important focus for sustainable building in these countries, and will also create a comprehensive overview from the Central European region for the global SB08 Conference, which will be held in Melbourne, Australia, in September 2008 (www.sb08melbourne.com).

PRINCIPAL CONFERENCE THEMES

- Economy, policy and legislation
- Assessment methods
- Education and information
- Building design
- Internal environment
- External environment
- Energy
- Materials





ABOUT iISBE, ABOUT CSBS

iISBE – The International Initiative for a Sustainable Built Environment is a non-profit organization whose overall aim is to actively facilitate and promote the adoption of policies, methods and tools that guide the international construction industry towards sustainable building practices. The main activities are managing and providing technical support for the international Sustainable Building Challenge (SBC) process focused on development and verification of a new methodology of evaluation of environmental performance of buildings, support and organizing of the international SB (Sustainable Building) conferences, development and operation of an information system SBIS and publications.

CSBS iISBE Czech – The Czech Sustainable Building Society is an official representative of iISBE in the Czech Republic. CSBS is a non-profit organization founded with the aim of promoting the ideas mentioned above in the specific national conditions of CR. It manages the development and introduction of a building complex evaluation system, supports educational activities and the web information system SUBSTANCE (www.substance.cz) related to sustainable built development.

ABOUT LEnSE



Methodology development towards a Label for **E**nvironmental, **S**ocial and **E**conomic buildings
LEnSE is a European research project that responds to the growing need in Europe for assessing a building's sustainability performance. The main objective of LEnSE is to develop a methodology for the assessment of the sustainability performance of existing, new and renovated buildings, which is broadly accepted by the European stakeholders involved in sustainable construction. More information on the project is available on www.lensebuildings.com.

SCIENTIFIC COMMITTEE

Petr HAJEK, Chairman (Czech Republic)

- Nils LARSSON, Vice-chairman (Canada)
- Andrea MORO, Vice-chairman (Italy)
- Jan TYWONIAK, Vice-chairman (Czech Republic)
- Zdenek BITTNAR (Czech Republic)
- Luís BRAGANÇA (Portugal)
- Robert CHARETTE (Canada)
- Pavol DURICA (Slovakia)
- Jozef HRASKA (Slovakia)
- Karel KABELE (Czech Republic)
- Wojtek KUJAWSKI (Canada)
- Thomas LÜTZKENDORF (Germany)

- Aleksander PANEK (Poland)
- Dusan PETRAS (Slovakia)
- Anton PUSKAR (Slovakia)
- Georg W. REINBERG (Austria)
- Ronald ROVERS (The Netherlands)
- Michael SCHMIDT (Germany)
- Jiri SEDLAK (Czech Republic)
- Jiri SEJNOHA (Czech Republic)
- Jiri SKOPEK (Canada)
- Petr STEPANEK (Czech Republic)
- Boguslaw WITKOWSKI (Belgium)
- Zdenek ZAVREL (Czech Republic)





HOST CZECH SUSTAINABLE BUILDING SOCIETY



CESB 07 PRAGUE Conference is organized by CSBS iISBE Czech in collaboration with the Centre for Integrated **DE**sign of **Ad**vanced **S**tructures (CIDEAS) of the Faculty of Civil Engineering, Czech Technical University in Prague.

csbs@fsv.cvut.cz

www.substance.cz/csbs

ORGANIZING COMMITTEE

Vlastimil SRUMA, Chairman (Czech Republic)

Antonin LUPISEK, Vice-chairman (Czech Republic)

Jan RUZICKA, Vice-chairman (Czech Republic)

Petr HAJEK (Czech Republic)

Petra JOHOVA (Czech Republic)

Jan MUKAROVSKY (Czech Republic)

Anton PUSKAR (Slovakia)

Jiri SEDLAK (Czech Republic)

Jan TYWONIAK (Czech Republic)

Jiri VICH (Czech Republic)

Martin VONKA (Czech Republic)

Vladimir ZDARA (Czech Republic)

LOCAL ORGANIZING AGENCY

CESB 07 PRAGUE Secretariat

CBS Servis, s. r. o.

Samcova 1, 110 00 Praha 1, Czech Republic

Tel.: +420 222 316 173, +420 222 316 195

Fax: +420 222 311 261

cesb@cbsservis.eu

www.cbsservis.eu/cesb07

IMPORTANT DATES FOR YOUR DIARY

15 May 2007	Submission of final papers
15 June 2007	Review and acceptance of papers by the Scientific Committee
30 June 2007	Deadline of the "early bird" registration
31 July 2007	Submission of any PR materials for Congress Proceedings
15 August 2007	Deadline of a registration for the standard fee
10 September 2007	Deadline of any form of commercial presentation

DATE AND PLACE

CESB 07 PRAGUE Conference will be held

on 24–26 September 2007

at Faculty of Civil Engineering, Czech Technical University (CTU) in Prague,

Thakurova 7, Prague 6

Czech Republic



Notice: The undermentioned CESB 07 Technical Programme may still be subject to some changes.

Sunday, 23 September 2007

19:00-21:00	WELCOME RECEPTION: Faculty of Civil Engineering, CTU in Prague, Atrium
--------------------	---

Day 1: Monday, 24 September 2007

09:00-10:30	HALL A
CONFERENCE OPENING	
WELCOME ADDRESSES	
	P. Hajek (Czech Republic)
SESSION M1A: KEYNOTE LECTURES 1	
Building the future – the building sector after 2012	
	N. Svemningesen (France)
Sustainable building overview 2007	
	N. Larsson (Canada)

10:30-11:00	COFFEE BREAK
--------------------	---------------------

11:00-12:30	HALL B
SESSION M2A: KEYNOTE LECTURES 2	
Rating systems in the public and financial sectors	
	A. Moro (Italy)
Lessons and challenges in sustainable buildings for the 21st century	
	R. Rovers (The Netherlands)
Sustainability assessment and/or property rating?	
	T. Lützkendorf, D. Lorenz, J. Kertes (Germany)

12:30-14:00	LUNCH BREAK
--------------------	--------------------

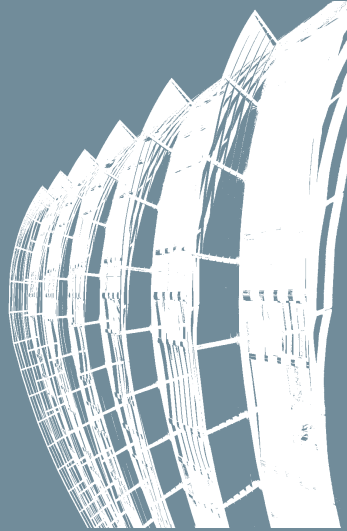

SPECIAL THEME EXPOSITION

Sustainability in Design and Construction in Germany

This special theme exposition will be exhibited along with the CESB07 poster session in the Main Atrium.

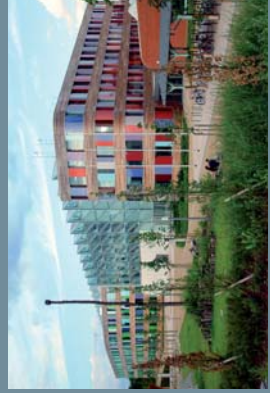

TECHNICAL PROGRAMME | MONDAY, 24 SEPTEMBER 2007



TECHNICAL PROGRAMME | MONDAY, 24 SEPTEMBER 2007

14:00-15:30	HALL C
SESSION M3C: ENERGY 1	
<p>Energy and environmental audit for sustainable buildings D. Petras (Slovakia)</p> <p>Zero-emission-buildings – terms, definitions and examples of implementation M. Kramp, K. Voss, M. Ufheil, S. Herkel, Ch. Neumann (Germany)</p> <p>Low energy and smart buildings – analysis of energy consumption in the all life cycle of building A. Stachowicz, M. Fedorczak-Cisak (Poland)</p> <p>Barriers of low-energy building development F. Macholdá (Czech Republic)</p> <p>Economy and energetic performance of semi-central concepts Ch. Drexler (Austria)</p>	

14:00-15:30	HALL B
SESSION M3B: BUILDING DESIGN 1	
<p>Energy efficient commercial building design – experiences and results from the German funding program energy optimized building, EnOB G. Löhnert, S. Herkel, K. Voss, A. Wagner (Germany)</p> <p>Geotectura's architecture: Energy, technology and social context J. Cory (Israel)</p> <p>MesseCenter-Weid – PassivhausStandard for energy-saving trade fairs H. Plöberl (Austria)</p> <p>Open building and sustainability in practice F. van der Weirf (The Netherlands)</p> <p>Design of net zero energy housing V. Straka, M. Gorgolewski (Canada)</p>	

14:00-15:30	HALL A
SESSION M3A: ECONOMY, POLICY AND LEGISLATION 1	
<p>Immo-Rate: Guide for the property rating of sustainable buildings R. Lechner (Austria)</p> <p>Cost planning for the renewal and maintenance over building life cycle J. Tomankova, D. Capova, L. Kiemlova, R. Schneiderova Heralova (Czech Republic)</p> <p>Urban eco-efficiency – positions and attitudes of urban development actors A. Blum (Germany)</p> <p>Strategy for sustainable development in the building sector of Russia, Kazakhstan and Ukraine Y. A. Matrosov (Russia)</p> <p>Resource conservation in existing commercial buildings J. B. Storey (New Zealand)</p>	

16:00-17:30	HALL C
SESSION M4C: ENERGY 2	
<p>Environmental payback of stone wool in a societal energy perspective A. U. Clausen (Denmark)</p> <p>Influence of micrometeorological conditions in a street canyon on energy characteristic of a building M. Idczak (Poland)</p> <p>Experimental examination of energy and micro-climate properties in two low-energy buildings F. Kulhanek (Czech Republic)</p> <p>Comparison of TRVs for Bratislava R. Rabenseifer, S. Hofmann, G. Levermore, J. Parkinson (Slovakia)</p> <p>Slab cooling system design using computer simulation M. Lain, F. Dikal, J. Hensen, V. Zmhal, M. Bartak (Czech Republic)</p>	

16:00-17:30	HALL B
SESSION M4B: BUILDING DESIGN 2	
<p>Sustainability of olympic buildings – guidelines for sustainable architecture of mega-sporting events N. Essig (Germany)</p> <p>Sustained development strategies in the aerhythmic architecture at the examples of building structures Z. Szpakowski, W. Rokicki (Poland)</p> <p>Passive house technology for multifamily residential buildings in Vienna and Lower Austria M. Treberspurg, U. Ertl (Austria)</p> <p>Holistic architecture O. Holzman (Czech Republic)</p> <p>How potential builders are testing passive houses H. Brückner, S. Eibensteiner, P. Schwarzwinger (Austria)</p>	

15:30-16:00	COFFEE BREAK	
16:00-17:30	HALL A	
SESSION M4A: ECONOMY, POLICY AND LEGISLATION 2		
<p>Green globes building performance assessment J. Skopek (Canada)</p> <p>Questionnaire survey of environmental attitudes, management and performance of Swedish architects and technical consultants L. Thuvander (Sweden)</p> <p>Bottom-up or top-down instruments for more sustainable buildings? S. Geisler (Austria)</p> <p>One m2 infrastructure for one m2 floor space? C. Dellmann, K. Gruhler, J. Hengersdorf (Germany)</p> <p>The building's value assessment using the utility and the LCC R. Schneiderova Heralova (Czech Republic)</p>		

Day 2: Tuesday, 25 September 2007

09:00-10:30	HALL A
SESSION 1A: KEYNOTE LECTURES 3	
Sustainable building in the Czech Republic - challenge and opportunity P. Hajek, J. Tywniak (Czech Republic)	
High- and ultra-high performance concrete: basis for sustainable concrete structures of the future M. Schmidt (Germany)	
Building with earth – 30 years of research and development at the University of Kassel G. Minko (Germany)	

10:30-11:00 COFFEE BREAK

11:00-12:30	HALL A
SESSION 12A: ASSESSMENT METHODS 1	
LISE methodology for sustainability assessment of buildings K. Putzeys, J. Van Dessel (Belgium)	
Cycle assessment (LCA): A first step toward sustainability T. Cole (USA)	
Optimizing integrated design through systematic requirement management D. Forgues (Canada)	
Environmental assessment of a low-energy house R. Rabenseifer (Slovakia)	
Optimization of concrete structures P. Stepanek (Czech Republic)	

12:30-14:00 LUNCH BREAK

11:00-12:30	HALL B
SESSION 12B: BUILDING DESIGN 3	
Trepulkaqaasse Wien – an example for sustainable building process G. W. Reinberg, P. Thalbauer (Austria)	
„Low-energy buildings“ ... in reality high energy? M. V. Jensen (Czech Republic)	
Integrated design of buildings on industry area: Case study from the standpoint structural static and stand-point energy D. Kubeckova Skulinova, K. Kubecka (Czech Republic)	
Slunakov ecological centre, Horka nad Moravou O. Holmeister, R. Brychta, A. Halir, P. Lesek (Czech Republic)	
The lessons learned in building in a sustainable manner by the Habitat Research and Development Centre, Windhoek, Namibia J. Korrubel, N. Maritz (Namibia)	

11:00-12:30	HALL C
SESSION 12C: ENERGY 3	
In search of equilibrium in Canadian housing W. Kujawski (Canada)	
Thermal heat storage for energy demand reduction in low-energy buildings M. Ostry (Czech Republic)	
Energy balance of windows solar gains and losses in passive houses M. Kalousek, P. Kudela (Czech Republic)	
Guidelines on supplementary artificial lighting related to Total Daylight Index (TDI) D. Heim, M. Jablonski, P. Klemm, E. Szczepanska (Poland)	
Intervention strategies on lighting systems in existing buildings towards energy efficiency and saving A. Frattari, R. Albatici, M. Chiogna (Italy)	



TECHNICAL PROGRAMME | TUESDAY, 25 SEPTEMBER 2007



TECHNICAL PROGRAMME | TUESDAY, 25 SEPTEMBER 2007

14:00-15:30	HALL C
SESSION T3C: MATERIALS 1	
Resource efficiency – the Cinderella of the efficiency debate H. Wallbaum, S. Krank, S. Kellenberger (Switzerland)	
Progressive secondary and recycled raw materials used in low energy and passive houses J. Sedlak, L. Matejka (Czech Republic)	
European situation of recycled materials in construction P. Alajójs, M. S. de Juan, D. C. Bricio (Spain)	
Use of straw bales in heat cladding – a cross-border project A. Brotanek (Czech Republic)	
PURR-e – a tool for green city design L. Swiątek (Poland)	

14:00-15:30	HALL B
SESSION T3B: BUILDING DESIGN 4	
Parametric design strategy aiming at environmentally sustainable residential buildings H. T. Hansen, M.-A. Knudstrup, P. Heiselberg (Denmark)	
Solar energy systems integrated in low-energy buildings. Motivation, strategies and built examples from Czech Republic J. Tywoniak, P. Moravek, K. Staneek, M. Zenka (Czech Republic)	
100% solar heated monolithic clay bloc house in Germany G. Dasch, K. Liepach (Germany)	
Three retrofit buildings facing passive house standard K. Wiriden (Switzerland)	
Promoting building integrated photovoltaics for a sustainable future A. Sey (Turkey)	

14:00-15:30	HALL A
SESSION T3A: ASSESSMENT METHODS 2	
Implementation of GB Tool in the Czech Republic M. Vontka, V. Zdara (Czech Republic)	
Aiming at sustainability by use of Life Cycle Cost Assessment in decision making in planning and design of new buildings and in refurbishment G. Kringsvoll, J. Karnik (Norway)	
Critical role of process in developing a green building rating system: The LEED for homes experience A. Edminster (USA)	
Green building rating system for developing countries – case of Jordan H. H. Ali, S. F. Al-Nasirai (Jordan)	
Designing and building green in Australia S. Burroughs (Australia)	

15:30-16:00 **COFFEE BREAK**

16:00-17:30	HALL C
SESSION T4C: MATERIALS 2	
Design for disassembly and recycling – using radio frequency identification (RFID) technology to facilitate whole life actions for sustainable construction G. Paterson, S. Taylor (UK), P. Crowther (Australia)	
Earthen architecture - regional cultural heritage I. Zabičkova, H. Urbaškova (Czech Republic)	
Green roofs: structural, physical, ecological and economical aspects G. Minke (Germany)	
Straw and earth: The sustainable materials of the past and the future M. V. Jensen, K. Holmanova (Czech Republic)	
Prefabricated load bearing wall panels – effective technologies for earthen structures J. Ruzicka (Czech Republic)	

16:00-17:30	HALL B
SESSION T4B: INTERNAL ENVIRONMENT	
Modelling of indoor environment quality in sustainable building K. Kabele, P. Dvorakova (Czech Republic)	
Physical cavity of double-skin facade – experiment in-situ M. Bielek, B. Bielek, D. Szabo (Slovakia)	
The influence of windscreen on wind flow K. Klemm (Poland)	
Solar and daylight rights in concept of performance based building J. Hraska (Slovakia)	
Acoustic aspects of sustainable building P. Oravec, M. Kozarkova (Czech Republic)	

16:00-17:30	HALL A
SESSION T4A: ASSESSMENT METHODS 3	
Procedure for the determination of lifetime and depreciation of buildings with annexes and extensions from the point of view of their valuation M. Tomko, S. Toth (Slovakia)	
Environmental and life cycle assessment of structural design of residential house – case study J. Ruzicka, C. Frala, A. Lupisek, J. Mukarovsky, J. Novak, M. Vontka, E. Zezulova (Czech Republic)	
Contribution of innovation technology to sustainable construction J. Gaspari, M. A. Barucco (Italy)	
Four brick passive houses with Total Quality certification G. Koch, N. Prommer (Austria)	
I-divergence function in project evaluation V. Beran, P. Dlak (Czech Republic)	

20:00-24:00 **SOCIAL EVENING: Bethlehem Chapel**

Day 3: Wednesday, 26 September 2007

09:00-10:30	HALL A
SESSION W1A: EDUCATION AND INFORMATION 1	
Becoming sustainable. How do you learn in demonstration projects? B. Rubino, M. Eden, P. Femenias (Sweden)	
Thermomodernisation of public buildings conducted in accordance with the conditions of sustainable development – STEP A. Panek, J. Sova (Poland)	
Data base of planning know how for passive houses T. Berger, P. Holzer (Austria)	
Experience of creation of system of SB education in building university A. Teitor (Russia)	
Human factors by designing the microenvironment/psychology and sociology of interior design V. Kotradyova (Slovakia)	

09:00-10:30	HALL B
SESSION W1B: EXTERNAL ENVIRONMENT 1	
Sustainable buildings in interaction M. Elle, B. Hoffmann, S. Batslev Nielsen (Denmark)	
Effects of future city developments – development scenarios of municipalities K. Grubler (Germany)	
Sustainable planning toolkit (SPT 1) M. Reza Helforoush (Austria)	
Tectonic landscapes: Tending to the wounds of Mother Earth B. F. Witkowski (Poland)	
Display of commerciality in architecture of industry buildings L. Ilkovicova, J. Ilkovic (Slovakia)	

09:00-10:30	HALL C
SESSION W1C: MATERIALS 3	
Dissolution of fibers used in insulating materials production M. Strnadova, J. Hamacek, A. Helebrant (Czech Republic)	
Industrial unfired loam brick buildings with passive house standard Ch. Kunze, K. Macho (Austria)	
Use of ignition lay in production of sintered fly ash aggregate V. Kalova, B. Vácenovska (Czech Republic)	
Burnt oil shale – main constituent of the portland cement L.-M. Raado, V. Nurm (Estonia)	
Mechanical and hygric properties of FGD gypsum modified by secondary raw materials P. Tesarek, M. Jerman, E. Mhahoncakova, R. Cerny (Czech Republic)	

10:30-11:00

COFFEE BREAK

11:00-12:30	HALL A
SESSION W2A: EDUCATION AND INFORMATION 2	
Postgraduate course Sustainable Construction at the TUG P. Mayrdl, K. Preparner (Austria)	
Postgraduate education in building science at Danube University Krems P. Holzer, R. Hammer (Austria)	
Buildings and energy – new master study programme at CTU in Prague K. Kabele, P. Hajek, J. Tywniak (Czech Republic)	
Environmental education & "Architects-in-Schools" movement A. Palei (Poland)	
TREES: Training for renovated energy efficient social housing B. Peuportier (France)	

11:00-12:30	HALL B
SESSION W2B: EXTERNAL ENVIRONMENT 2	
Harmonising energy, food and waste systems in the built environment L. Devany, R. Cook (UK)	
Study on the building conversion for temporary use by public sector T. Eguchi, S. Matsumura, M. Tsunoda, A. Inagawa, R. Mitate (Japan)	
Evaluation of the pedestrian comfort in the designed building surrounding D. Galokci, P. Durica (Slovakia)	
Deep ecologization as topical basis of ecological construction A. Teitor (Russia)	
Influence of the urban structure on microclimatic conditions in virtual residential districts K. Klemm (Poland)	

11:00-12:30	HALL C
SESSION W2C: MATERIALS 4	
Environmentally based optimization of RC slab floor structures C. Fiaba, P. Hajek (Czech Republic)	
Simulation of behaviour of FRC with recycled aggregate A. Kohoutkova, J. Broukalova (Czech Republic)	
Concrete mix and environmental load in the context of durability and reliability P. Rovnanik, P. Rovnanikova, B. Tepy (Czech Republic)	
Replacement of cement-based grouting and filling components by waste materials P. Matulova (Czech Republic)	
Column behaviour of austenitic steel hollow sections M. Jandera, J. Machacek (Czech Republic)	

12:40-13:30

12:40-13:30	HALL A
SESSION W3A: PANEL DISCUSSION	
CONFERENCE CLOSING	
P. Hajek (Czech Republic)	

13:30-14:30

13:30-14:30	LUNCH BREAK
-------------	-------------



TECHNICAL PROGRAMME | WEDNESDAY, 26 SEPTEMBER 2007



PLAN OF THE CONFERENCE AREA

FIRST FLOOR

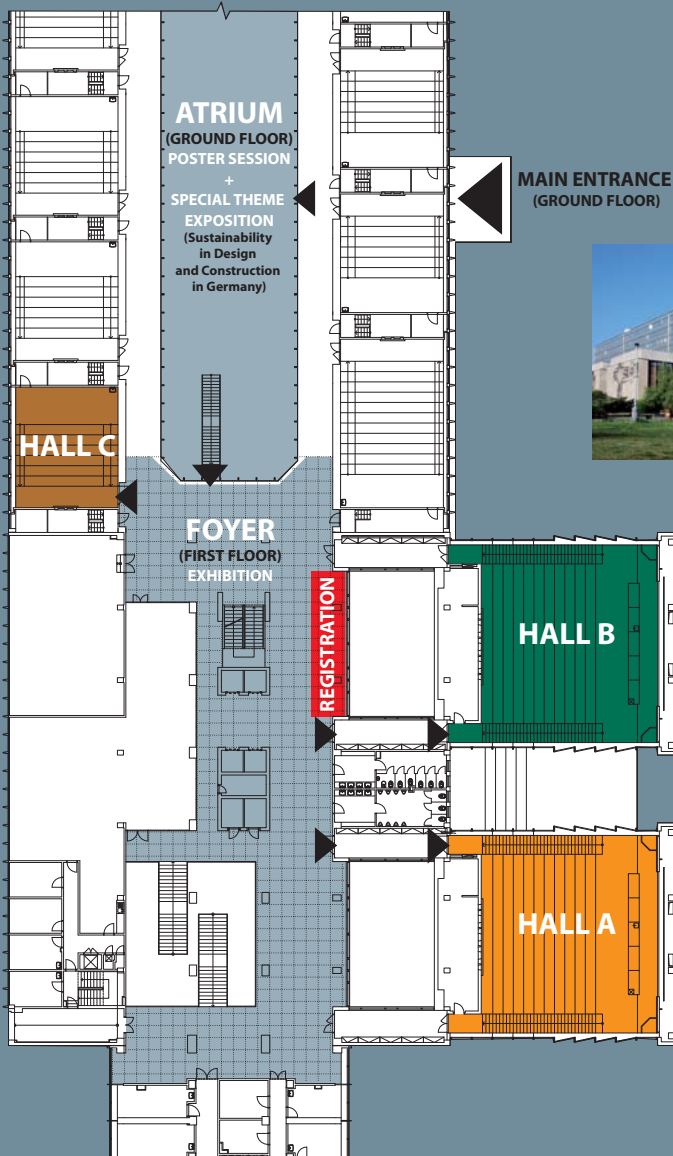



POSTER SESSION

Since the number of submitted abstracts has been much greater than the places available for oral presentation, the Conference offers the floor for Poster Session in Main Atrium. Time will be reserved and specified for that Poster Session in the Final Programme. The authors are then expected to be present at the poster location to answer questions from Conference participants.

There are more than 40 posters expected in the CESB 07 PRAGUE Conference Poster Session. All of them will be printed/published in full in the Conference Proceedings/CD.

LEnSE WORKSHOP



In association with the CESB 07 PRAGUE Conference, LEnSE is organising its third Transnational Expert Workshop on Wednesday, 26 September 2007.

The workshop will focus on the results of the practical testing of the developed LEnSE methodology.

In the morning, there will be a closed session with invited experts. The afternoon session of the workshop (14:30–16:30) is open to all CESB participants. The aim of this session is to demonstrate the LEnSE prototype tool for sustainability assessment on real case studies, followed by a strategic discussion on the possible implementation of the LEnSE method.

TECHNICAL EXCURSION

Low-energy Houses in Nenacovice and Unetice

Half-day visit to examples of low-energy buildings, newly built near Prague will be arranged in the afternoon on Wednesday, 26 September. The coaches will depart from the Conference venue at 14:30, returning back at about 18:00.

The unused agricultural area in Nenacovice was consequently transformed into a new headquarter of company Country Life (agricultural bio-products). Existing buildings were refurbished and extended with new buildings at passive house level (natural materials, green roofs, solar thermal system, rain water collection, etc).

The triple-family house in Unetice was designed in order to guarantee the privacy at maximum use of a small plot. Wooden based sandwich structure at low-energy house level is used there to good purpose.





WELCOME TO PRAGUE

Prague, a city with over a thousand-year history, was established and developed at the intersection of strategic routes connecting key centres on the European continent. Its leading position and favourable climate led to successful development of trade, arts and crafts, scientific research and knowledge. The past centuries have left their mark primarily in art and architecture. Through the course of time, Prague has gained a reputation as a major European centre of culture, education and humanism. In recent years, Prague has become a top tourist destination and has been recognised by UNESCO as a gem of the world's cultural heritage. The unique magic of our city is down to the outstanding quality of its architectural sights and to a harmonious relationship between the various historical styles. It is this harmony that helps to create an environment of mutual understanding, tolerance, respect and partnership.



CONGRESS VENUE

The CESB 07 PRAGUE Conference takes place in the Faculty of Civil Engineering building complex, which is an organic part of the CTU in Prague (ČVUT in Czech). Plenary session and all parallel sessions will be organized in auditoriums and lecture halls of Buildings B and C. The poster session will be arranged in the Main Atrium of Building C, and the CESB 07 Exhibition in foyers of Building B – both immediately next to the Conference Halls A, B and C (see the plan).





CESB 07 EXHIBITION | COMMERCIAL PRESENTATION

Conference Exhibition

A technical/commercial exhibition will be organized along with the Conference to demonstrate new technologies, materials, products and services of organizations which are active in sustainable building. The exhibition will be located in foyers of the Faculty of Civil Engineering, CTU in Prague in the middle of Conference Halls. All the organizations, individuals and whoever else interested in the exhibition and in introducing themselves to the Central European specialists and business partners are cordially invited.

More information about the CESB 07 Exhibition and the Exhibition Booth Application Form are available on website www.cbsservis.eu/cesb07 and will be sent on request in printed version as well.

Exhibition Facilities

Generally, three kinds of exhibition facilities are offered for CESB 07 Exhibition:

- Stands of OCTANORM type (or of your own type), standard arranged area of 6 m² (3 x 2 m)
- Exhibition panel 1 (width) x 2.1 (height) m with a hard white surface
- Exhibition area of 3 x 2 m for free exhibition of your own

Detailed information can be found and any specific type of exhibition facilities can be ordered on website www.cbsservis.eu/cesb07. For all interested in CESB 07 Exhibition a detailed Exhibition Plan is available there, so they could select an accurate location for their stand.

Commercial Presentation

In addition to an attendance at the CESB 07 Exhibition the organizer offers a variety of possible forms of commercial presentations. There is a placement of a company advertisement in Conference Proceedings, a placement of a company logo in the Main Atrium, billing of a company name and logo on the official Conference website or inserting printed materials of a company into the Conference Bags among them.

Sponsorship Opportunities

Exciting opportunities are available for organizations to become involved as sponsors of CESB 07 PRAGUE Conference or of an important part of it, i.e. Social Evening or Technical Excursion. A broad range of packages are available to encourage both small and large companies to be represented at this important event. For further information regarding exhibition and sponsorship please contact the Local Organizing Agency.





PRELIMINARY EXHIBITION PLAN

GROUND FLOOR

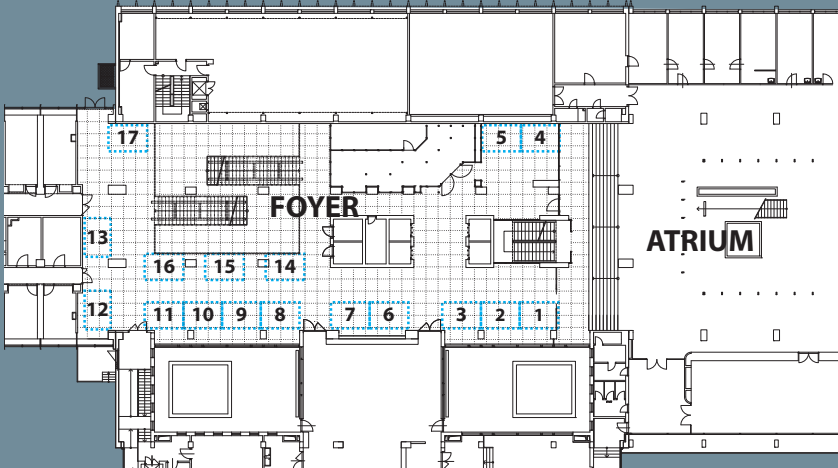

FIRST FLOOR

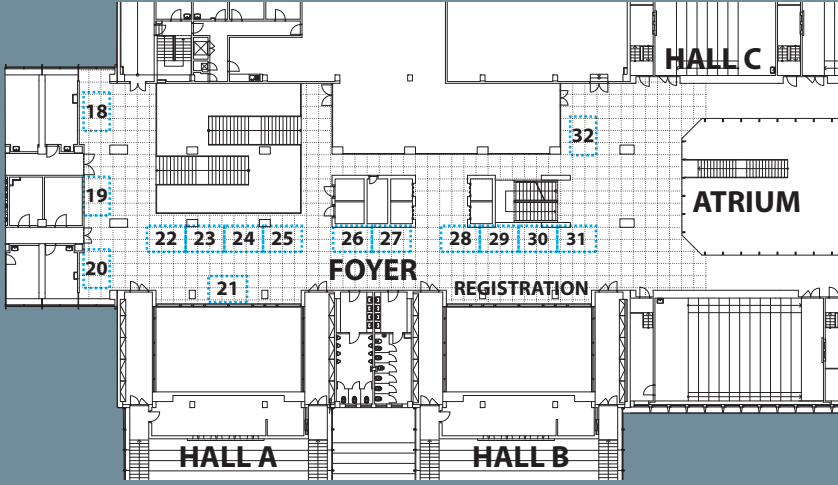



GENERAL INFORMATION

Registration

Application for registration and reservation for the CESB 07 technical programme, social evenings, a technical excursion and a guided tour should be made by enclosed CESB 07 Registration Form. You can also find this Form as a PDF file on the website www.cbsservis.eu/cesb07.

Registration Fees

Registration fees will be charged (either in EUR or in CZK) according to the following table of prices. In the case of students sending a clear written proof of ongoing study is required.

Type of Registration	By 30 June 2007	By 15 August 2007	After 15 August 2007
Regular	EUR 250/CZK 7000	EUR 300/CZK 8400	EUR 350/CZK 9800
Main author	EUR 200/CZK 5600	EUR 250/CZK 7000	EUR 300/CZK 8400
Member of csbs and CBS	EUR 200/CZK 5600	EUR 250/CZK 7000	EUR 300/CZK 8400
Student	EUR 120/CZK 3360	EUR 150/CZK 4200	EUR 180/CZK 5040
Accompanying person	EUR 80/CZK 2240	EUR 100/CZK 2800	EUR 120/CZK 3360

All the prices include VAT already.

Registration Entitlements

Registration fee for participants includes:

- Attendance to the Welcome Reception
- Attendance to the Conference Opening and to all the lecture sessions
- Attendance to the Panel Discussion and Conference Closing
- One copy of Conference Proceedings and CD
- Conference Bag with set of technical/commercial/traveller materials
- Visit to the CESB 07 Exhibition
- Lunches, teas/coffees and refreshment at breaks

Registration fee for an accompanying person includes:

- Attendance to the Welcome Reception and to Session M1A (Conference Opening, Welcome Addresses and Keynote Lectures 1)
- Tea/coffee and refreshment at the morning break on Monday, 24 September
- Attendance to the Session W3A (Panel Discussion and Conference Closing)
- Prague sightseeing tour
- Conference Bag with set of traveller materials
- Visit to the CESB 07 Exhibition

Other Conference services on offer:

- | | | |
|---|-----------------|------------------|
| ■ Guided tour to the Southern Bohemia | 22-23 September | EUR 260/CZK 7280 |
| ■ Prague sightseeing tour | 25 September | EUR 25/CZK 700 |
| ■ Social Evening in Bethlehem Chapel | 25 September | EUR 50/CZK 1400 |
| ■ Technical visit to Nenacovice and Unetice | 26 September | EUR 30/CZK 840 |





GENERAL INFORMATION

General Terms of Payment

Payment is required together with the Conference Registration Form. Please select the items from the Registration Form that are applicable to you. Payment of Conference fee, social programme and other ordered services (including an hotel accommodation) can be made to the Conference organizer CBS Service by bank transfer only either in Czech crowns (CZK) or in Euros (EUR). Please do not pay by bank cheques.

Banking details:

Remittance should be made to the following account:

Account No. 190470299/0300 | Account name: CBS Servis, 110 00 Praha 1, Samcova 1

Bank: CSOB, a. s., Praha 1, Na Porici 24, IBAN CZ57 0300 0000 0001 9047 0299, Swift Code: CEKOCZPP

Please do not forget to state: (a) your family name, (b) "CESB 07" as a reference to your payment!

Please note that all banking fees have to be settled by the remitter.

A copy of the bank transfer stating the name(s) of the participant(s) for whom payment is made should be attached to the Conference Registration Form (see the Form for details). Please note that no registration can be put through if payment is not received.

Confirmation of Registration

Confirmation of registration will be acknowledged by Conference organizer upon receipt of payment as soon as practicable. That confirmation will contain your reference (registration) number. Please state that reference number in case of any other communication with the Conference organizers. Please keep your confirmation of registration and present it at the Conference Registration Desk.

Cancellation Fees

Written notification (by post, e-mail or fax) is required for any cancellation. There will be issued full refunds, less 20 EUR/560 CZK for cancellations received until 31 August 2007 to meet the administrative costs. There will be 50% refunds only after 31 August 2007 and no refunds issued for cancellation received after 15 September 2007.

Participant substitutions may be made at any time at no additional charge.

Refunds will be made after the event, by 31 October 2007.

Registration Desk On-site

The Conference Registration Desk in Building B of the Faculty of Civil Engineering will be open as follows:

- Sunday, 23 September 2007: 17:00 – 19:00
- Monday and Tuesday, 24 and 25 September 2007: 07:30 – 16:00
- Wednesday, 26 September 2007: 07:30 – 14:00

Congress Proceedings and CD

A set of Conference Proceedings and CD in a special Conference Bag will contain all papers accepted by the Scientific Committee for presentation in lecture sessions or in poster session. It will be generally distributed to the participants at the time of registration. However it will be possible to collect it at any time at the open Conference Registration Desk.





TECHNICAL INFORMATION

Official Language

The official language of the Conference will be English. All speeches and posters will be in English only. In addition, simultaneous translation into Czech of all plenary and some parallel sessions will be arranged.

Earphones

Earphones will be available on-site against the deposit of your ID card (driving licence and the like). Please return the earphones at the end of each working day and collect your ID card. Missing earphones will be charged to the respective participants.

Letter of Invitation

The Conference host association will be pleased to send an official letter of invitation upon request. It is understood that such an invitation is intended to help potential attendees raise travel funds or obtain a visa. It is not a commitment of the Conference organizer to provide any financial support.

Liability

The organizers do not assume any liability for personal or property losses suffered by Conference participants and accompanying persons.

Currency and Banking Facilities

Current approximate exchange rates (May 2007) of the Czech currency, Czech crown (CZK) is as follows:

1 EUR 28.0 CZK

100 CZK ... 3.5 EUR

There are many standard facilities to exchange foreign currency for Czech crowns everywhere in the Czech Republic. Many hotels, restaurants and bigger shops accept also payment in EUR.

Local Transportation

There is an efficient underground, tram and bus transport network in Prague (www.dp-praha.cz, also in English and German). The Conference venue is within an easy walking distance (10 minutes) from the Dejvicka underground station (green Line A) – see the plan





SOCIAL PROGRAMME

Social activities will include:

- Guided pre-conference tour to the historical towns and places of Southern Bohemia, some of them on the list of UNESCO world's cultural heritage, on 22-23 September 2007
- Welcome Reception on 23 September 2007,
- Social Evening in the old-time Bethlehem Chapel with dinner and cultural programme on 25 September 2007
- Prague Sightseeing Tour on 24 September 2007

Guided Tour to the Southern Bohemia (SP1)

Date: Saturday and Sunday, 22-23 September 2007

Price: 260 EUR/7280 CZK

Departure: 22 September, 8:30 from the entrance to the Diplomat hotel

Return: 23 September, 17:00 to the same place

Starting at the Diplomat Hotel, the guided coach tour will lead at first to the town of Tabor, a well-preserved medieval town on Luznice River. A short conducted tour there will acquaint you with many picturesque Gothic houses from 14th and 15th century. After lunch there you will continue to the beautiful medieval town Cesky Krumlov, which is also called the Pearl of Southern Bohemia. There is a unique continuously built-up area of late Gothic and Renaissance houses there. The dominating feature of the town is a castle which was founded in the 13th century. The visit to the castle and its well-known round tower are part of the programme. The 4-star hotel Zlaty andel here will be your accommodation for the night (both single/double bed rooms are available).

The following morning you can spend on a visit to the castle of Hluboka which will grab your attention with its monumentality. In the early 13th century there was a Gothic castle here. In the 19th century the rest of the castle was completely rebuilt in the romantic Windsor style. After lunch you can continue to the beautiful castle of Konopiste, former hunting lodge once surrounded by deer forest. The visit of the castle provides a unique opportunity to familiarize with a typical lifestyle of the family of Habsburg.





SOCIAL PROGRAMME

Welcome Reception (SP2)

Date and time: Sunday, 23 September 2007, 19:00-21:00

Venue: Main Atrium of the Faculty of Civil Engineering, CTU in Prague

Address: Thakurova 7, Prague 6

Price: included in the Conference fee

After registering, the CESB 07 participants will meet friends, old and new, in the impressive Main Atrium of the Faculty of Civil Engineering of the Czech Technical University. A light refreshment and drinks will be offered to guests there.

Prague Sightseeing Tour (SP3)

Date and time: Tuesday, 25 September 2007, 09:30-13:00

Price: 25 EUR/700 CZK

The sightseeing tour to Prague Castle and the Old Town with a professional guide will start from the Conference venue by bus. The tour of Prague Castle, the seat of Czech kings, begins at the Riding School, leading past the Royal Garden over the Powder Bridge and to the 2nd courtyard with the Chapel of St. Cross. In the 1st courtyard, you can admire its magnificent gate, and then proceed to the 3rd courtyard with the St. Vitus Cathedral. Then you will see the Old Royal Palace, the St. George Basilica, as well as many other gems of Czech architecture. The walking tour continues across Charles Bridge to the Old Town. Charles Bridge, which was built during the rule of Charles IV in the second half of the 14th century is decorated with unique statues. The tour includes St. Salvatore Church, the Church of St. Francesco of Assisi in the Krizovnické Sq., the Old Town Bridge Tower, St. Nicholas Church, the Old Town Square with the Tyn Cathedral, you will be able to see the Old Town Hall with the historical astronomical clock. Finally, you will pass through the Jewish Quarter with the Klaus, Old-New and Maisel synagogues.





SOCIAL PROGRAMME | HOTEL ACCOMMODATION

Social Evening in Bethlehem Chapel (SP4)

Date and time: Tuesday, 25 September 2007, 20:00-24:00

Venue: Bethlehem Chapel in the Old Town

Address: Betlemske namesti , Prague 1

Price: 50 EUR/1400 CZK

This Conference primary social affair will be held in a unique environment of the Gothic Bethlehem Chapel. This is the site where, in the early 15th century, the firebrand Czech Protestant theologian Jan Hus raised the ire of the Catholic hierarchy with sermons critical of the establishment. He was burned at the stake as a heretic in 1415 at Konstanz in present-day Germany and became a martyr for the Czech Protestant and later nationalist cause.

A special combined evening programme will be offered to the Evening guests there. Among others the concert of music in swing style and a dinner party will be on the programme.



HOTEL ACCOMMODATION

Preferential Hotel Rates

Accommodation for the Conference has been arranged and will be managed directly by the CBS Servis Agency, CESB 07 Secretariat. Preferential room rates are offered to Conference participants at a set of Prague's hotels at different price levels, most hotels are within easy reach of the Conference venue. Only delegates booking accommodation through CBS Service can be guaranteed these significantly reduced rates.





HOTEL ACCOMMODATION

How to Reserve a Hotel Room

Hotel reservation should be made before **15 August 2007** by using the enclosed Conference Registration Form and by sending a deposit equivalent to at least the cost of two night's stay (sending your hotel payment en block is welcome). Please make your hotel reservation as early as possible. Applications received after this date will be satisfied on an availability basis. A limited number of rooms are reserved in the following hotels:

Conference Hotels	Category	Address	Single Room	Double Room
Praha	*****	Prague 6, Susicka 20	EUR 135/CZK 3780	EUR 155/CZK 4340
Diplomat	****	Prague 6, Evropska 15	EUR 155/CZK 4340	EUR 175/CZK 4900
Rott	****	Prague 1, Male nam. 4	EUR 155/CZK 4340	EUR 170/CZK 4760
Modra Ruze	****	Prague 1, Rytirska 16	EUR 140/CZK 3920	EUR 170/CZK 4760
Crowne Plaza	****	Prague 6, Koulova 15	EUR 140/CZK 3920	EUR 160/CZK 4480
Julis	***	Prague 1, Vaclavske nam. 22	EUR 120/CZK 3360	EUR 150/CZK 4200
Ibis Wenceslaw Sq.	***	Prague 2, Katerinska 36	EUR 110/CZK 3080	EUR 125/CZK 3500
Krystal	***	Prague 6, J. Martiho 2	EUR 60/CZK 1680	EUR 80/CZK 2240
Masarykova kolej	***	Prague 6, Thakurova 1	EUR 55/CZK 1540	EUR 75/CZK 2100
Patanka Boarding House	***	Prague 6, Patanka 4	EUR 40/CZK 1120	EUR 60/CZK 1680

All the prices are per night/room, incl. breakfast, VAT and all other taxes. The CBS Servis reserves the right to book you a similar hotel should your preferred hotel be fully booked.

Confirmation of Reservation and Hotel Voucher

After your deposit is received by CBS Servis, your room reservation will be confirmed to you by e-mail. The rest of your hotel payment should be received again by CBS Servis by **15 August 2007**. Once we receive your entire hotel payment, you will receive a written confirmation, including a hotel voucher, by e-mail.

Reservation Changes or Cancellations

Any changes or cancellations of reservation must be addressed to CBS Service and not directly to the hotel. Notification of cancellations can only be accepted in writing. The following cancellation fee (see the table below) will be deducted from the refunded hotel payment.

Term	Cancellation fee
Until 15 August 2007	Administration costs of 20 EUR/560 CZK
Until 31 August 2007 (24 days before)	Cost of two-nights accommodation (deposit)
Until 15 September 2007	50% of hotel payment balance (minimum deposit!)
After 15 September 2007	100% of hotel payment balance

Refunds

Refunds will be made after the event, by 31 October 2007.



INVITATION



Czech Concrete Society
www.cbsbeton.eu
and
CBS Servis, s. r. o.
www.cbsservis.eu

INTERPRETING CZECH ↔ ENGLISH

Conference 14th CONCRETE DAY 2007 and Exhibition **BETON 2007**

Under the Auspices of
Ministry of Transport
Ministry of Environment
Ministry of Industry and Trade
President SPŠ in CR

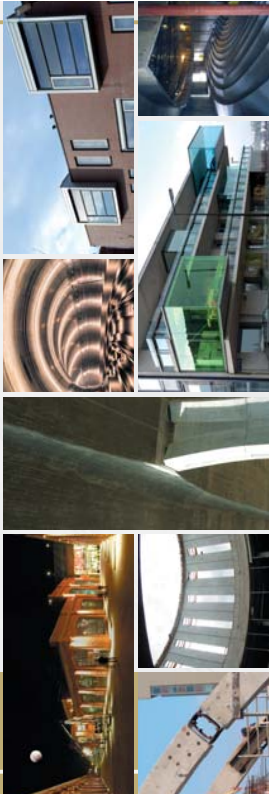

28 and 29 November 2007
Hradec Králové, Congress Centre ALDIS

sb08 MELBOURNE

WORLD
SUSTAINABLE
BUILDING
CONFERENCE



5808 Melbourne
Melbourne Convention Centre
21 -25 September 2008
www.sb08melbourne.com





PLAN OF VICINITY OF THE CONFERENCE VENUE IN PRAGUE 6



PRAHA
PRAGUE
PRAGA
PRAG



Bus 119 – direct connection to the Ruzyne Airport

CONFERENCE WEBSITES

Production and organization

(registration, accommodation, finance issues, exhibition, presentation, accommodation, ...)

www.cbsservis.eu/cesb07

Technical Programme,

Scientific Committee

www.substance.cz/cesb07

